



CityLink Tulla Widening

Flemington Road / Mount Alexander Road interchange upgrade

The CityLink Tulla Widening project will increase capacity, ease congestion and provide a smoother and more reliable journey for people travelling between Melbourne Airport and the CBD by adding an extra lane in each direction, a state-of-the-art freeway management system and upgrading key interchanges.

About the upgrade

The Flemington Road/Mount Alexander Road interchange will be upgraded to improve safety and help this extremely busy and complex interchange work better.

This upgrade will add and reconfigure lanes to improve the way traffic moves through the area, resulting in more reliable trips for those travelling inbound on CityLink and around the Flemington Road/Mount Alexander Road interchange.

Key improvements are highlighted on a map over the page.

Why is this upgrade needed?

This critical section of our road network is no longer able to cope with the high volumes of traffic that pass through it each day and the wide range of different vehicle movements made within a short section of road.

Merging and weaving on Flemington Road

With so many drivers needing to merge within a very short distance on Flemington Road, safety and congestion problems are common. Anyone who drives this route knows how difficult it can be to change lanes here, which is often necessary to reach your destination.

There have been 12 crashes here in the last five years, and this year alone three people have been seriously injured in crashes at this location.

The interchange upgrade will help by separating and controlling traffic movements to reduce the merging and weaving that causes safety and congestion problems.

Freeway exit ramp congestion and safety

Traffic on the CityLink Flemington Road exit ramp queues back onto the freeway almost every morning during peak. It's a safety concern when fast moving traffic is passing slow or stationary vehicles in the next lane. This congestion also has a flow-on effect, causing delays right back along the freeway.

The CityLink Tulla Widening project will create extra lanes on the ramp to keep traffic queues separated from fast moving freeway traffic, improving safety and traffic flow and helping the freeway to operate as it should.



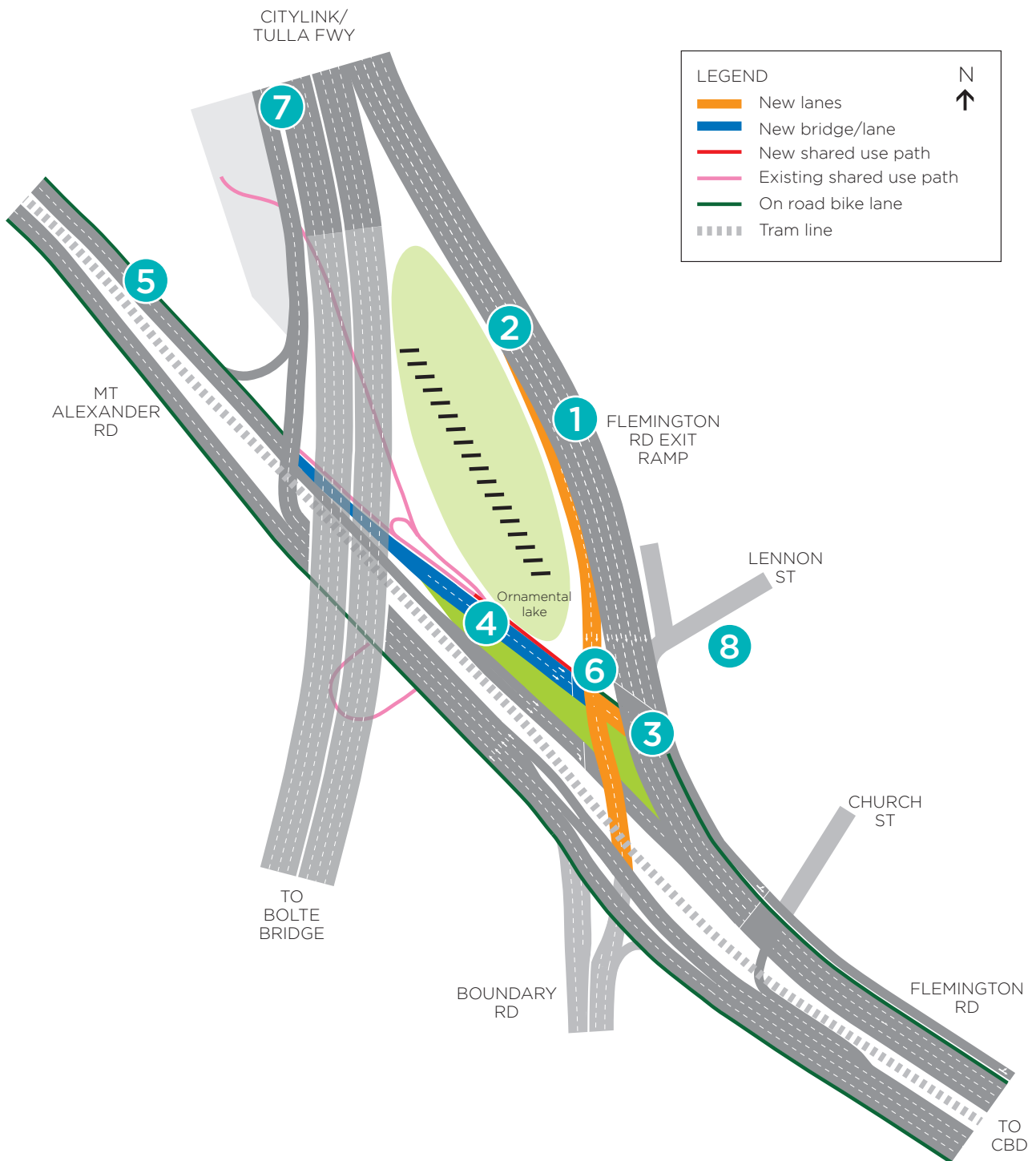

Flemington Road / Mount Alexander Road interchange

As design is still ongoing, this information is subject to change

What's involved in the upgrade?

The diagram on the opposite page highlights key improvements being made at the Flemington Road /Mount Alexander Road interchange as part of the CityLink Tulla Widening project.

Freeway exit ramp to Flemington Road

- 1 Two additional lanes will stop queues stretching back onto the freeway to improve freeway safety and traffic flow.
- 2 Drivers will need to choose their destination earlier, using the right lanes for Boundary Road and inner Flemington Road lanes, and the left lanes for Church Street, Elliot Avenue and outer Flemington Road lanes.
- 3 New traffic signals will control traffic flow through this intersection to improve safety by reducing the number of traffic movements happening at one time and make it easier for people to get to their destination.

Mount Alexander Road (citybound)

- 4 Two new inbound traffic lanes (on a bridge over Moonee Ponds Creek) will make it easier and safer for drivers to access Elliot Avenue, by removing the need to merge across several traffic lanes and compete with freeway traffic. This will also help reduce queuing on Mount Alexander Road (inbound), which can cause delays for drivers and trams.
- 5 Drivers will need to choose their destination earlier, using the right lane for Boundary Road and inner Flemington Road lanes, and the left lane for Church Street, Elliot Avenue and outer Flemington Road lanes.
- 6 The existing bike lanes on Mount Alexander Road and Flemington Road will be connected with a new section of bike lane, improving connectivity and safety for cyclists heading toward the CBD or to Elliot Avenue.



Freeway entry ramp (outbound)

- 7 Ramp widening and lengthening and traffic signals on the entry ramp will improve traffic flow onto the freeway and reduce queuing on Mount Alexander Road.

Changes to access from Lennon Street

- 8 This upgrade will result in changes to access from Lennon Street. It will no longer be possible to travel directly across the Flemington Road freeway exit ramp from Lennon Street to Boundary Road.

While this is currently possible, it involves crossing four lanes of traffic exiting the freeway, with poor visibility.

Drivers who travel from Lennon Street to Boundary Road will need to use an alternative route. Road users and local residents will be notified before this change comes into effect.

This upgrade will improve the way traffic moves through the area to help this busy interchange work better.





We will provide advance notice of any major disruption to residents and drivers and clearly sign and communicate detour routes.

Project status and timing

Leighton Contractors is designing and constructing the CityLink Tulla Widening project from Bulla Road to Power Street. Works began on 5 October 2015 and will be completed in 2018.

In the Flemington Road area, most major construction activity will be undertaken during 2016, including construction of the new traffic lanes and shared path on Mount Alexander Road.

Access from Lennon Street to Boundary Road will be available until early 2016. Following this, it will no longer be possible to travel directly across the Flemington Road freeway exit ramp from Lennon Street to Boundary Road. Access to Flemington Road inbound will be maintained.

Construction

We acknowledge that works over an extended period of time can be disruptive to residents. We're doing everything we can to minimise that disruption.

We will keep you informed of major works ahead of time, particularly when working outside normal construction hours of 7am to 6pm Monday to Saturday. Night and weekend works are sometimes necessary to keep workers safe and minimise traffic disruption.

All freeway lanes will remain open during peak travel times to keep traffic moving. Drivers can expect to see reduced speed limits and there will be overnight lane closures on the freeway and connecting roads, ramp closures and occasional half or full freeway closures.

We will provide advance notice of any major disruption and clearly sign and communicate detours.

Cyclists and pedestrians may also notice changed conditions or detours of shared use paths or footpaths, including along the Moonee Ponds Creek trail. We will always provide a safe and clearly signed detour.



Contact Details

For further information
Call **1300 783 947**
Monday to Friday, 9am to 5pm

Email citylinktullawidening@roads.vic.gov.au
Visit citylinktullawidening.vic.gov.au
#CTWidening



Australian Government

BUILDING OUR FUTURE

